

Light Source

Specification & User Manual

2007 VER A

Table of Contents

1. Description and Features.....	3
2. Specification.....	4
3. Operating Instructions.....	5
4. Maintenance	6
5. Warranty.....	6
6. Ordering Information	7
7. Service Contacts.....	7

1.1 Description

Light Source is a handy tool and instrument to provide you several different wavelengths to test the fiber equipment in the optical network and FTTx construction. Light Source is ideal for field or laboratory testing of optical communication system at 850 nm / 1300 nm for datacom testing, 1310 nm / 1550 nm / CWDM 1270 nm ~ 1610 nm (20 nm spans) for all WDM testing , as well as 1490 nm for FTTx testing by changing interchangeable SFP module. Light Source features zero warm up, superb productivity and is easy to use with pocket-size and rugged and handy design.



With LC / SC patch cord , Light Source can be used for all the most widespread fiber interfaces such as LC / ST / SC / FC connector. It is suitable to test both Singlemode and Multimode cables.

Internally there is also a specifically designed power circuit included; the APC (Auto Power Control) circuit provides steady power which avoids unstable laser output when the battery is low.

The LD output signal can be switched CW or Pulse Mode 270 Hz / 2 KHz Modulated Mode to simulate signal transmission. There is a dust proof cap which will prevent dust from getting into the inside of the LD connector. The cap also helps evade incidental exposure of the laser directly into your eyes.

1.2 Features

- Pocket-size & rugged & handy design.
- Needless to pre-warm-up time.
- Interchangeable SFP Module design.
- Flexible to change any wavelength.
- High stability of the Output Power.

- Excellent & stable output wavelength.
- Excellent re-connection repeatability.
- Low Voltage Battery warning signal in LED.
- Compatible to LC Connectors.
- Economic type and easy to use.
- Operates in CW (Continuous Wave) or Pulse Mode 270 Hz / 2 KHz
- The dust-proof design keeps fiber connectors clean
- Two AAA-size alkaline batteries
- LED indicator for Power, Battery Low indicators

1.3 Application

- Maintenance CATV / Telecom / FTTH in Singlemode or Multimode fiber optical fiber network.
- Standard laboratories.
- High throughput quality assurance.

2. Specification

Laser Class	Class 1
Wavelength (nm)	850, 1300, 1310, 1550 1270, 1290, 1310, 1330, 1350, 1370, 1390, 1410, 1430, 1450, 1470, 1490, 1510, 1530, 1550, 1570, 1590, 1610,1625
Output Power	> 0.5 mW @ 25°C into 9 μm fiber
Mode	CW / Pulse Mode 270 Hz / 2 KHz
Battery Type	AAA 1.5 V x 2
LED Indicator	Power On (GREEN) / Battery Low (RED)
Output Power Accuracy	+/- 0.2 dB
Output Power Stability (1 HR)	+/- 0.05 dB
Operating Temp.	0°C ~ 50°C
Storage Temp.	0°C ~ 70°C

3. Operating Instructions

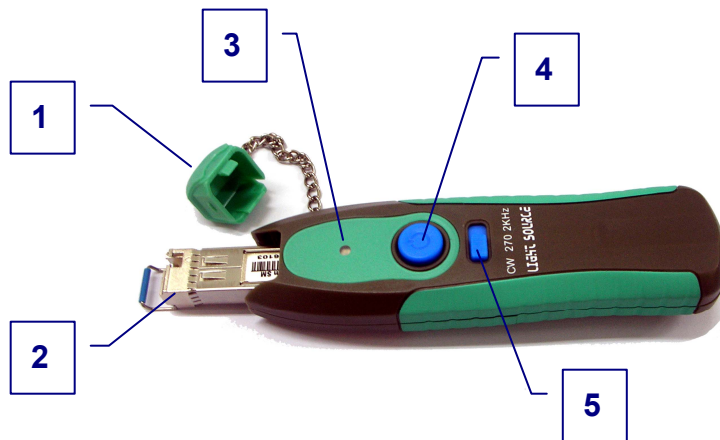

To press to release Linchpin then to push Battery Lid backward.

To open Battery Lid to change batteries.

1. Dust Cap : prevent dirt contaminates the LD .
2. SFP Module : Interchangeable single LC connector hot swap SFP module for identical wavelength.
3. LED Indicator : Power On and In Operation indicator (GREEN) and Battery Low Warning indicator (RED) .
4. Button : pressing to Turn On / Turn Off the LD emitting.
5. Mode Switch : to select CW Continuous Wave Mode / Pulse Mode 270 Hz / 2 KHz Switch.
6. Pen Clip : a design to fasten the tool while put inside pocket.
7. Battery Lid : to open to change batteries.
8. Linchpin : a mechanical design to lock the Battery Lid.

1. The Light Source is powered by two pieces 1.5 V AAA batteries.
2. To initiate Light Source internal calibration, press Button and check if the LED is GREEN.
3. To press Button to Turn Off Light Source.

4. Lift the front of the Dust Cap and insert on end of the fiber connector to the LC connector or directly insert to a connector of the fiber or LC / SC / FC patch cord.
5. Switch to select to CW Mode or Pulse Mode 270 Hz / 2 KHz.
6. To press the Button to Turn On Light Source. LED Indicator now is GREEN while the Light Source is in operation.
7. To press the Button second time to Turn Off Light Source. The LED Indicator will be turned off.
8. When the LED Indicator is RED, this means batteries are almost drained out and in low voltage status. You will need to replace the batteries right away to keep the tool in right functions.
9. Do not touch the Light Source SFP LC connector to avoid dirt into the connector.
10. Keep the Dust Cap closed all the time while the Light Source is not in use.
11. With proper cleaning tools to clean the Light Source SFP LC connector before testing so that to obtain best results and keep the Light Source service longer.

4. Maintenance

This tool requires no maintenance other than periodic battery charges. Like any other electronic equipment, this tool should be kept away from water, high damp, dust, electricity, and environments of extreme temperature. Do not drop this tool on hard surface. Modifying internally any of this tool components can cause a malfunction and will invalid the manufacturer's warranty.

5. Warranty

The manufacturer warrants this product to be free of defects in workmanship and materials for a period of 1 year after purchase. This warranty (excluding batteries) is solely limited to the repair and replacement of original parts, which are defective in workmanship of materials. All other costs should be the sole responsibility of the owner. This warranty does not cover any defects, damage, and deterioration due to misuse, alteration, or negligence.

6. Ordering Information:

Part Number	Source	Wavelength	Remark
S20012009999	NONE	NONE	Main Frame
S20012200850	VCSEL	850 nm	Single LC connector with identical wavelength SFP for Light Source.
S20012201300	LED	1300 nm	
S20012301310	FP LD	1310 nm	
S20012301550	FP LD	1550 nm	
S20012401310	DFB LD	1310 nm	
S20012401550	DFB LD	1550 nm	
S2001250 <u>1270~1610</u>	CWDM DFB LD	1270 nm ~ 1610 nm	

7. Service Contacts

Please contact us :

Liverage Technology Inc.
3F-3, No. 30 Taiyuan Street,
Chupei City, Hsinchu County 302,
Taiwan

TEL: +886-3-5525268

FAX: +886-3-5525388

e-mail: sales@liverage.com.tw

<http://www.liverage.com.tw>